

HEAVY HEX BOLTS - ASME B18.2.1

Heavy Hex Bolts and Setscrews have a larger head than standard Hex Head Bolts are available off the shelf in grades B7, L7 & B8M. These are available in Imperial and Metric threads and can be coated or plated to suit customer requirements as requested.

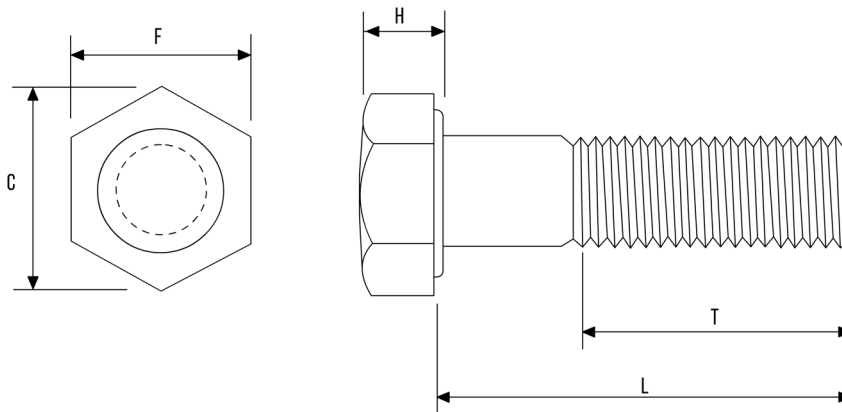

DIA (D)	A/F (F)			A/C (C)		HEIGHT (H)			THREAD (T)	
	BASIC	MAX	MIN	MAX	MIN	BASIC	MAX	MIN	L ≤ 6"	L > 6"
1/2	7/8	0.875	0.850	1.010	0.969	11/32	0.364	0.302	1.25	1.50
5/8	1.1/6	1.062	1.031	1.227	1.175	27/64	0.444	0.378	1.50	1.75
3/4	1.1/4	1.250	1.212	1.443	1.383	1/2	0.524	0.455	1.75	2.00
7/8	1.7/16	1.438	1.394	1.660	1.589	37/64	0.604	0.531	2.00	2.25
1	1.5/8	1.625	1.575	1.876	1.796	43/64	0.700	0.591	2.25	2.50
1.1/8	1.13/16	1.812	1.756	2.093	2.002	3/4	0.780	0.658	2.50	2.75
1.1/4	2	2.000	1.938	2.309	2.209	27/32	0.876	0.749	2.75	3.00
1.3/8	2.3/16	2.188	2.119	2.526	2.416	29/32	0.940	0.810	3.00	3.25
1.1/2	2.3/8	2.375	2.300	2.742	2.622	1	1.036	0.902	3.25	3.50
1.5/8	2.9/16	2.562	2.481	2.959	2.829	1.3/32	1.116	0.978	3.50	3.75
1.3/4	2.3/4	2.750	2.662	3.175	3.035	1.5/32	1.196	1.054	3.75	4.00
1.7/8	2.15/16	2.938	2.844	3.392	3.242	1.1/4	1.276	1.130	4.00	4.25
2	3.1/8	3.125	3.025	3.608	3.449	1.11/32	1.388	1.175	4.25	4.50
2.1/4	3.1/2	3.500	3.388	4.041	3.862	1.1/2	1.548	1.327	4.75	5.00
2.1/2	3.7/8	3.875	3.750	4.474	4.275	1.21/32	1.708	1.479	5.25	5.50
2.3/4	4.1/4	4.250	4.112	4.907	4.688	1.13/16	1.869	1.632	5.75	6.00
3	4.5/8	4.625	4.475	5.340	5.102	2	2.060	1.815	6.25	6.50

- All dimensions are in inches
- Thread lengths apply to bolts only. Setscrews are fully threaded.